

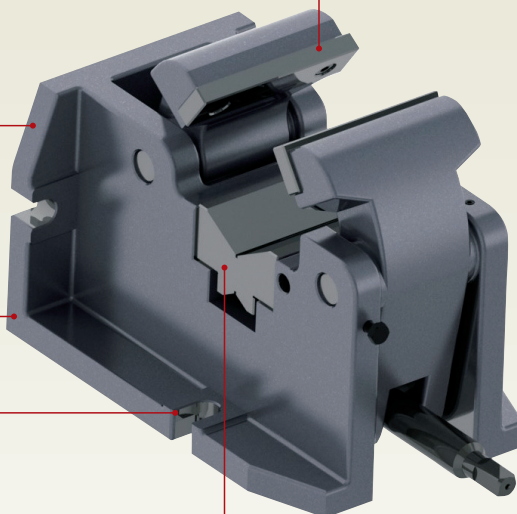

- Mechanical Vise for clamping of shaft.
- Suitable for horizontal and vertical applications.
- Alloy Steel Jaw which is flame hardened and precision ground ensures the accuracy.
- The parallelism and squareness of slots beneath vise base are very precise. Vise can be quickly positioned and fixed on the machining tables.
- Hypercapnia Alloy Steel Jaw which is flame hardened to HRC52~56 and precision ground to ensure the accuracy.
- Two-way jaw design is able to clamp circular workpiece within  $\varnothing 10\sim 160\text{mm}$ .

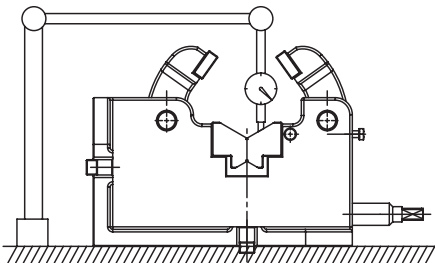
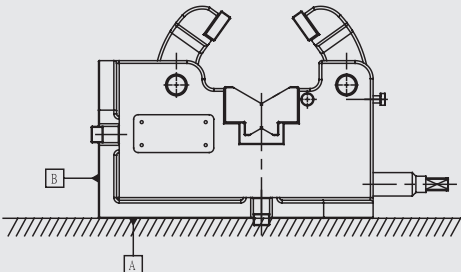

### Accuracy Inspection

	Inspection Items	Tolerance
1	 <p>Parallelism : V block to Vise bed</p>	$\pm 0.05/100\text{mm}$
2	 <p>Squareness : between A and B</p>	$\pm 0.05/100\text{mm}$

### HWY-SV100 / 125 / 150

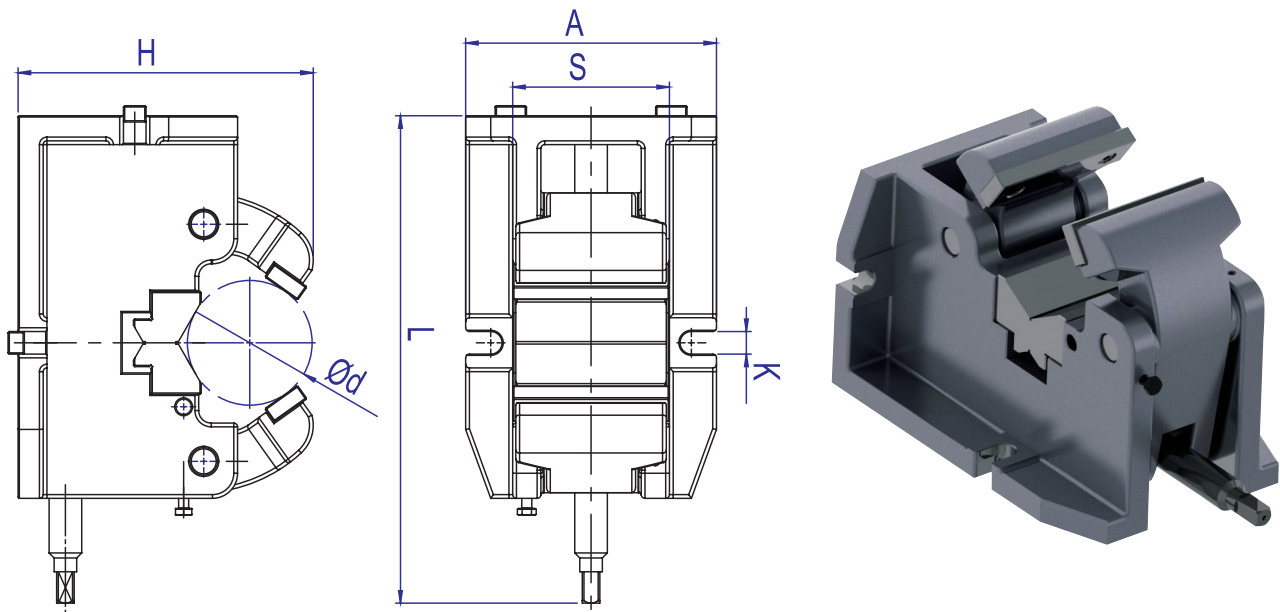

Model NO.	S	A	H	L	d	K	Max. Clamp. Force (kg)	N.W. (kg)
HWY-SV100	100	180	170	305	10~63	18	1000	22
HWY-SV125	125	200	235	405	15~100	18	1500	40
HWY-SV150	160	245	295	460	50~160	18	2000	75

Unit : mm

### Standard Accessory



Handle

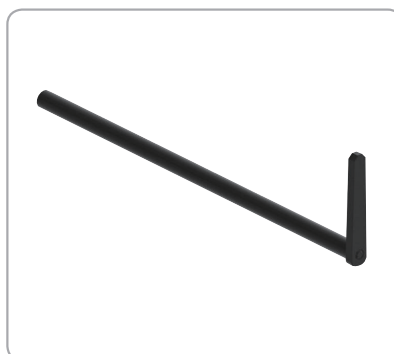

Stop Dog