

TECHNICAL FEATURES :
 Max speed : 6000rpm
 Max torque : 25Nm
 Ratio : 1:1
 Output : ER20

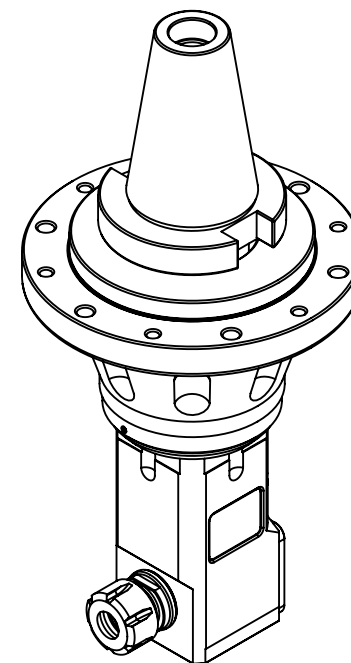

Machine type :

SK50



豪力輝工業股份有限公司
 HOLD WELL INDUSTRIAL CO.,LTD

E-mail : sales@mail.holdwell.com
<http://www.holdwell.com>

品號
 Model No.

品名
 Description

AHK-SK50-A7

K型 SK50-ER20
 90度鎖固式橫向銑頭